

NOTES:

TOPSOIL & HYDROSEEDING TO ALL AREAS WHERE EARTH HAS BEEN LEVELED OR MOUNDED.

REFER TO CIVIL DRAWINGS FOR LEVELS & PAVING.

ALL AREAS NOT NOMINATED WITH A HATCH OR CODE ARE EXISTING SURFACES. CONTRACTOR TO PROTECT AND MAKE GOOD ANY DAMAGE CAUSED BY WORKS.

GARDEN BEDS: EXISTING TREES AND PLANTING TO BE PRESERVED AND PROTECTED UNLESS NOMINATED FOR DEMOLITION / REMOVAL. REMOVE SOIL OR GRAVEL FROM GARDEN BEDS AS REQUIRED PRIOR TO PROVIDING NEW MULCH.

COLOUR NEW CONCRETE TO MATCH EXISTING WHERE ADJACENT TO EXISTING, OR WHERE USED TO PATCH HOLE WHERE COLUMN OR TREE IS REMOVED.

REFER TO LANDSCAPE DRAWINGS FOR ALL NEW PLANTING, AND TREES TO BE REMOVED AND RETAINED.

UNLESS NOTED OTHERWISE, REFER TO LANDSCAPE DRAWINGS FOR TYPES OF OUTDOOR FURNITURE SUCH AS BENCH SEATS.

- LEGEND**
- HARD LANDSCAPING**
- CONCRETE PAVING WITH WOOD FLOAT FINISH TO ENGINEERS DETAILS.
 - EXPOSED AGGREGATE CONCRETE PAVING TO ENGINEERS DETAILS.
 - HEAVY DUTY VEHICULAR CONCRETE PAVEMENT TO CIVIL ENGINEER DETAIL
 - RAISED HEAVY DUTY VEHICULAR CONCRETE PAVEMENT TO CIVIL ENGINEER DETAILS
 - VEHICULAR CARPARK ASPHALT PAVEMENT TO CIVIL ENGINEER DETAILS
 - VEHICULAR ROAD ASPHALT PAVEMENT TO TRAFFIC ENGINEER'S REPORT
- SOFT LANDSCAPING**
- MULCH GARDEN BED WITH SELECTED PLANTING AS PER LANDSCAPE DOCUMENTATION
 - GRANITIC GARDEN BED WITH SELECTED PLANTING AS PER LANDSCAPE DOCUMENTATION
 - TURF OVER 150mm GRASS - TOP SOIL AS PER LANDSCAPE DOCUMENTATION
 - RAIN GARDEN AS PER LANDSCAPE DOCUMENTATION
- GIVE WAY SIGN
- EXISTING TREE (T₁) TO BE RETAINED
- TREE PROTECTION ZONE IN ACCORDANCE WITH ARBORIST'S REPORT

DP	DOWNPIPE - REFER HYDRAULICS DRAWINGS		
FH	FIRE HYDRANT		
RD	ROLLER DOOR		
	Primary Draft Proposed Title Boundary	23/11/2020	
	BP3 Submission	26/10/2020	
	BP2 Submission	15/10/2020	
	BP2 Submission	24/09/2020	
EV	DESCRIPTION	DATE	

Contractors must verify all dimensions on site before commencement of any work or making of any shop drawings. Inform Architect of any discrepancies. Do not scale off drawings. All drawings to be read in conjunction with each other and the Specification.

Brand Architects

Level 8, 176 Wellington Parade,
East Melbourne, Victoria, 3002
brandarc@brandarchitects.com.au

JOB NO.4991

DAREBIN MULTI-SPORTS STADIUM

281 DAREBIN ROAD
THORNBURY VIC 3071

OVERALL SITE PLAN

QA STATUS:APPROVED	DRAWN: DR/CF
DATE: 10/09/2020	SCALE: As indicated

A02 [C 4]

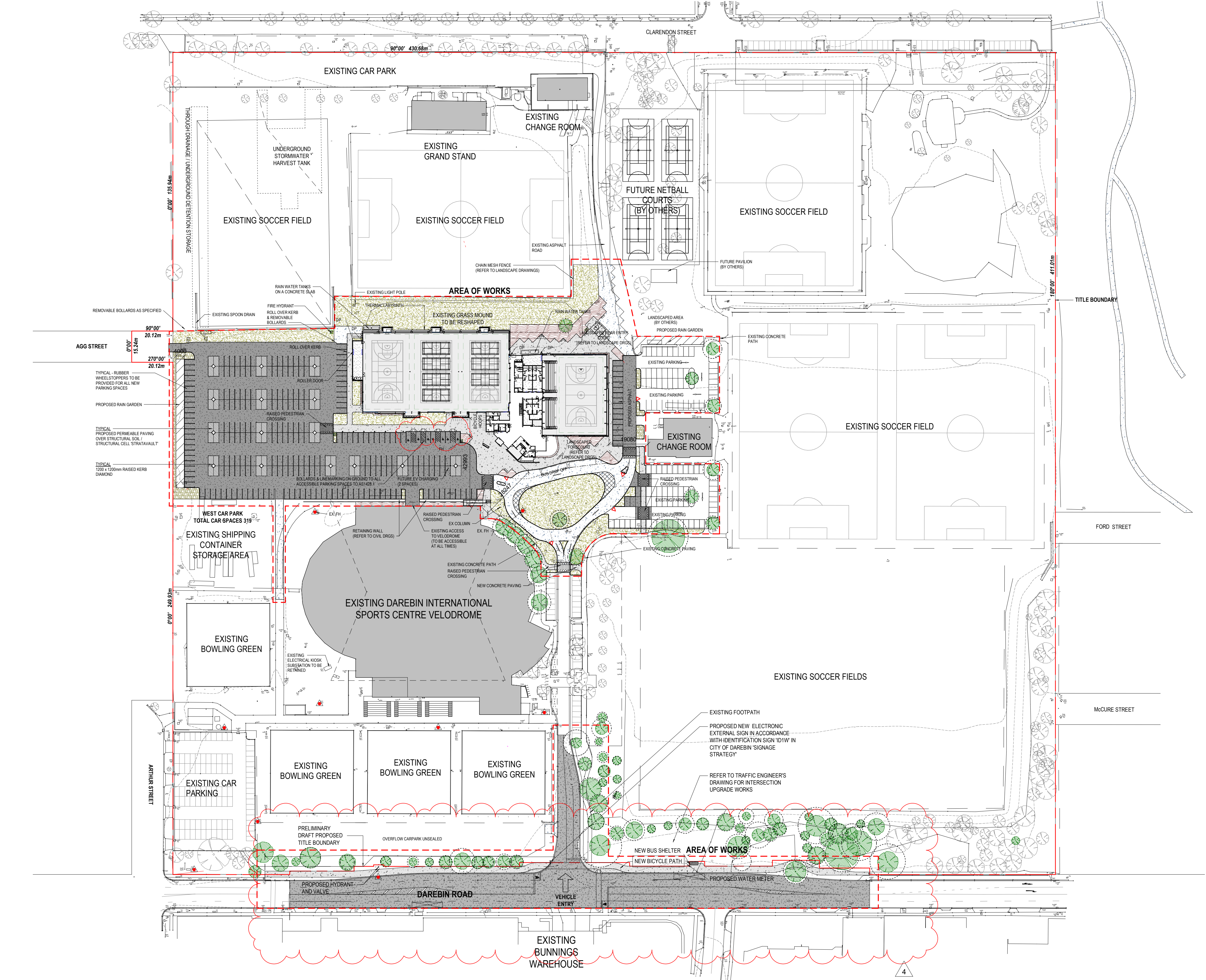

PROPOSED SITE PLAN
1 : 1000